

TAXI CHART (Page 1)

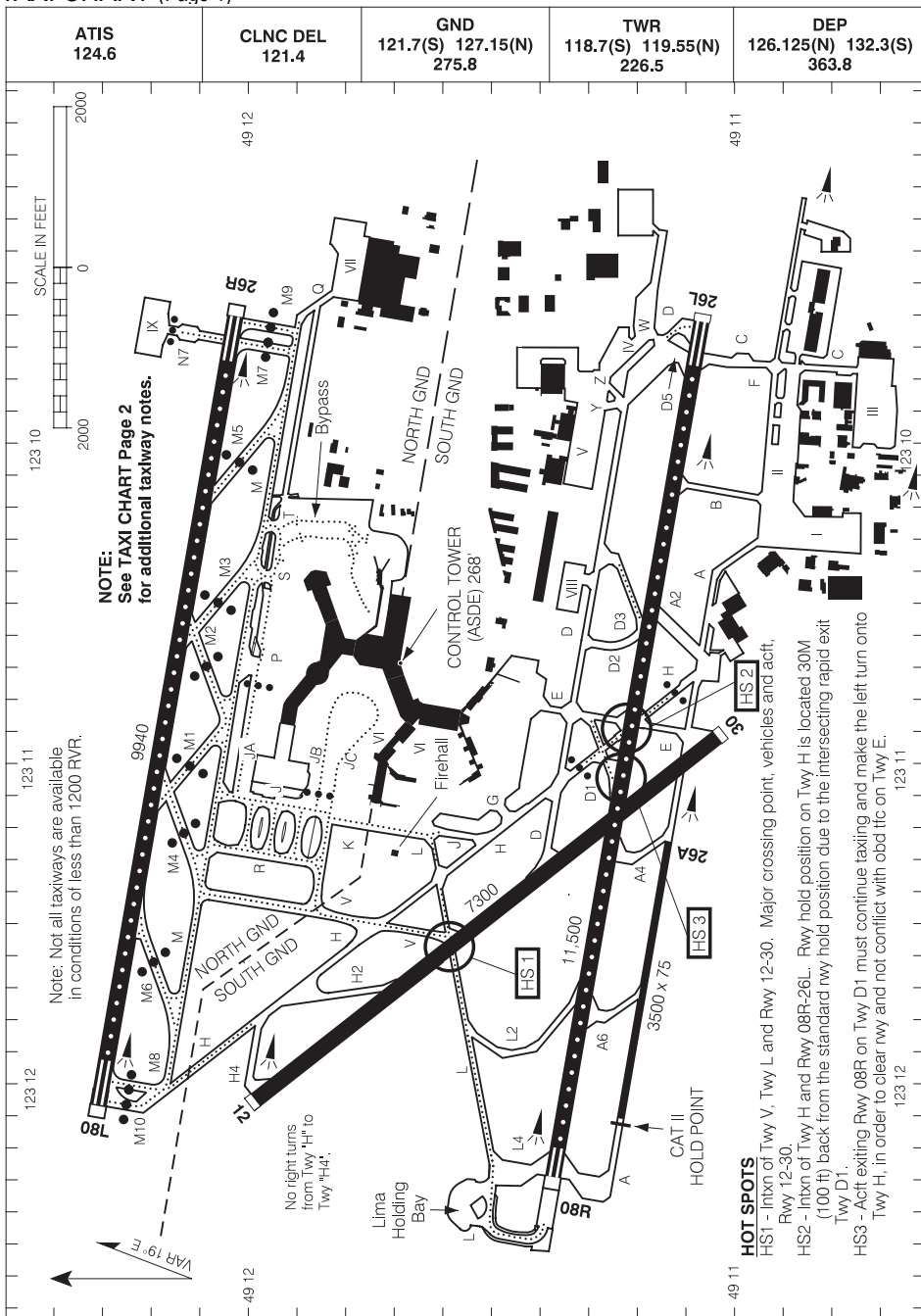

Source of Canadian Civil Aeronautical Data : © 2009 NAV CANADA All rights reserved

TAXI CHART

TAXI CHART (Page 2)

NOTESRWY 08L ARRIVALS

Reverse turns to exit rwy not authorized. Turbo-jets equipped with reverse thrust plan to exit Twy "M3" or beyond. A340-600/B777-300 exit Twys M5/M7/M9.

RWY 08R ARRIVALS

A340-600/B777-300 exit Twys D/D5.

Acft exiting onto "D1", turn north on "H" & hold short of "D". Do not stop in rwy area. See HOT SPOT 3.

RWY 26R ARRIVALS

Reverse turns not authorized turbo-jet. Turbo-prop auth daytime hrs only with prior approval. Turbo-jets equipped with reverse thrust plan to exit Twy "M4" or beyond. A340-600/B777 - 300 exit Twys M6/M8/M10.

RWY 26L ARRIVALS

Turns onto Rwy 30 NOT AUTHORIZED without clearance. A340-600/B777-300 exit Twy L.

A340-600/B777-300 PROHIBITED TAXIWAYS:

A, A2, A4, A6, B, C, D2, D3, F, G, H, (south of 08R/26L), H2, H4, L2 & S. 26L arrivals must exit Twy L.

WIDE BODY A/C RESTRICTIONS EXCEPT B767/A310/A300:

Twy "D5", "D" restricted from simultaneous use. Apron "VI" - exit from Twy "G" and "S" not avbl; no right turns onto Twy "L". Twy "L" - no right turns on to apron "VI". Twy "C" north of Twy "F" not avbl. Twy "H" - no right turns onto "H4" or "D". Twy "J" no left turns onto Twy "L".

CODED TAXI ROUTES

READ BACK: "CODE ROUTE (code) AND ASSIGNED RUNWAY"

Monitor tower frequency approaching the hold line of the assigned runway,
unless otherwise instructed by ATC.

Rwy 08R/26L - TWR 118.7 Rwy 08L/26R - TWR 119.55

Code	Taxi Route
Echo	Rwy 08R - E, D, H, hold short L. Rwy 08L - E, D, H, hold short V, contact ground 127.15 (expect taxi via H, M, M10). Rwy 26R - E, D, H, hold short V, contact ground 127.15 (expect taxi via V, M, M9). Rwy 26L - E, D.
Golf	Rwy 08R - G, H, hold short L. Rwy 08L - G, H, hold short V, contact ground 127.15 (expect taxi via H, M, M10). Rwy 26R - G, H, hold short V, contact ground 127.15 (expect taxi via V, M, M9). Rwy 26L - G, H, D.
Juliet-Alfa*	Rwy 08R - JA, J, K, V, hold short H, contact ground 121.7 (expect taxi via V, L). Rwy 08L - JA, J, M, M10. Rwy 26R - JA, J, M, M9. Rwy 26L - JA, J, K, V, hold short H, contact ground 121.7 (expect taxi via H, D).
Juliet-Bravo*	Rwy 08R - JB, J, K, V, hold short H, contact ground 121.7 (expect taxi via V, L). Rwy 08L - JB, J, M, M10. Rwy 26R - JB, J, M, M9. Rwy 26L - JB, J, K, V, hold short H, contact ground 121.7 (expect taxi via H, D).
Juliet-Charlie*	Rwy 08R - JC, K, V, hold short H, contact ground 121.7 (expect taxi via V, L). Rwy 08L - JC, J, M, M10. Rwy 26R - JC, J, M, M9. Rwy 26L - JC, K, V, hold short H, contact ground 121.7 (expect taxi via H, D).
Lima	Rwy 08L - L, H, hold short V, contact ground 127.15 (expect taxi via H, M, M10). Rwy 26R - L, H, hold short V, contact ground 127.15 (expect taxi via V, M, M9). Rwy 26L - L, J, H, D.
Papa*	Rwy 08R - P, M, V, hold short H, contact ground 121.7 (expect taxi via V, L). Rwy 08L - P, M, M10. Rwy 26R - P, M, M9. Rwy 26L - P, M, V, hold short H, contact ground 121.7 (expect taxi via H, D).
Sierra	Rwy 08R - S, M, V, hold short H, contact ground 121.7 (expect taxi via V, L). Rwy 08L - S, M, M10. Rwy 26R - S, M, M9. Rwy 26L - S, M, V, hold short H, contact ground 121.7 (expect taxi H, D).
Tango*	Rwy 08R - T, M, V, hold short H, contact ground 121.7 (expect taxi via V, L). Rwy 08L - T, M, M10. Rwy 26R - T, M, M9. Rwy 26L - T, M, V, hold short H, contact ground 121.7 (expect taxi via H, D).

*A340-600/B777-300 Taxi Routes

CODED TAXI ROUTES

DE-ICING FACILITY

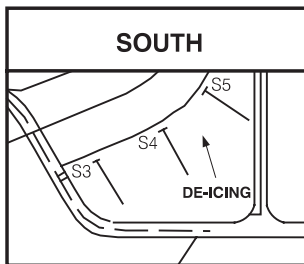
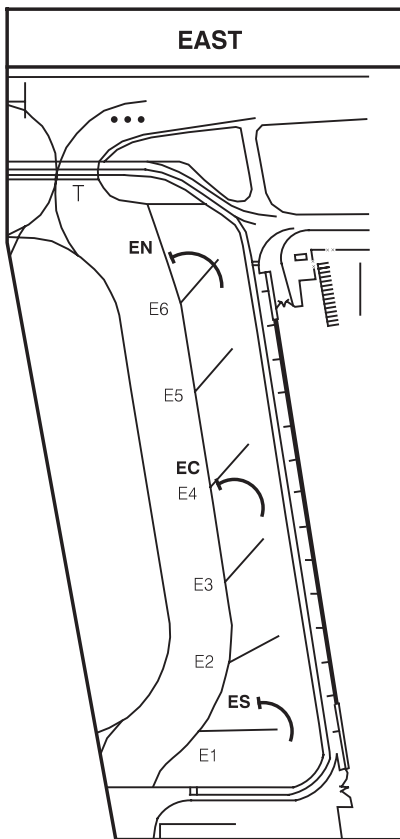
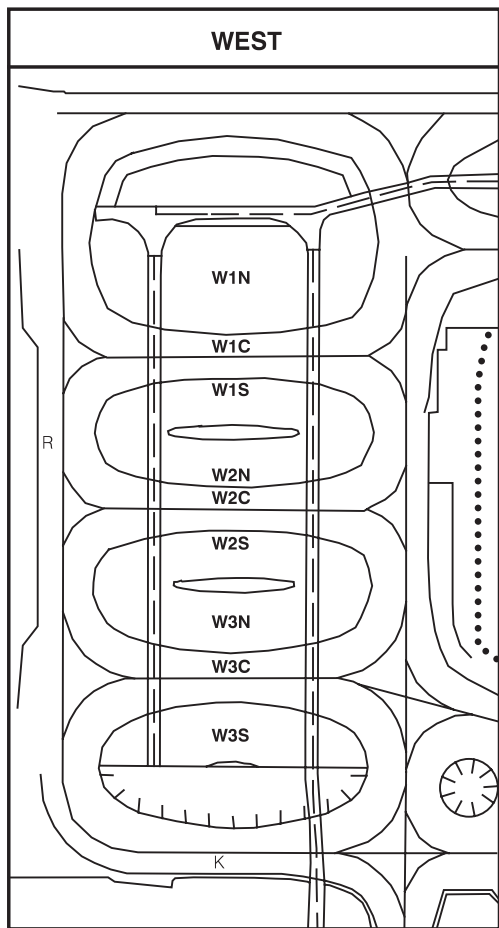

Source of Canadian Civil Aeronautical Data : © 2009 NAV CANADA All rights reserved

DE-ICING FACILITY